

## PowerDolphin

PowerDolphin is a water-surface vehicle that can sail autonomously. Equipped with a robotic camera arm the PowerDolphin can shoot 4k video and take 12 MP photos above and below the water surface. In addition, you can attach the PowerSeeker sonar to the bottom of the PowerDolphin, to locate fish, check water temps, and render terrains. You can also attach our bait container or attach a fishing line to the payload feature on the back of the PowerDolphin for precise bait drops. The remote controller and the Vision+ 2 App provide real-time image transmission and many other features.

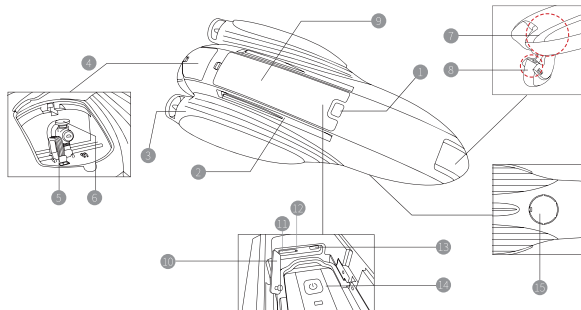

- ① On/Off button
- ② Radio antenna
- ③ Propeller
- ④ Payload system
- ⑤ Hook

- ⑥ Fitting pin
- ⑦ Camera electric joint
- ⑧ Camera manual joint
- ⑨ Battery cover
- ⑩ Rubber plug

- ⑪ MicroSD card slot
- ⑫ Reset button
- ⑬ Micro USB port
- ⑭ Intelligent battery
- ⑮ Fish finder port

## Remote Controller

You can use the remote controller to operate your PowerDolphin wirelessly, and display real-time low latency high resolution image's back to your mobile device through the Vision+ 2 App. In addition, the collapsible mobile device stand folds right into the remote and can hold most size iOS and android mobile phone.

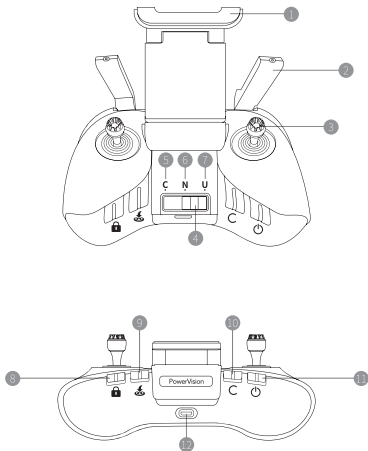

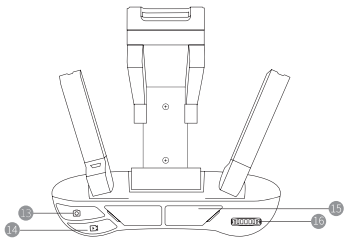

- |                       |                                 |                                   |
|-----------------------|---------------------------------|-----------------------------------|
| ① Mobile device stand | ⑦ Underwater mode (U)           | ⑪ Power button                    |
| ② Antenna             | ⑧ Lock/Unlock button            | ⑫ Charging port (Micro USB)       |
| ③ Control stick       | ⑨ Smart return button           | ⑬ Photo button                    |
| ④ Mode buttons        | ⑩ Custom button                 | ⑭ Video button                    |
| ⑤ Cruise mode (C)     | (Unhook/Bait button by default; | ⑮ Image transmission port (USB)   |
| ⑥ Normal mode (N)     | can be customized in the App)   | ⑯ Camera joint control thumbwheel |

- Underwater mode (U): suitable for low-speed, underwater scenarios like snorkeling. The maximum speed is restricted; the camera electric joint can be adjusted for many different views.
- Normal mode (N): This mode is for general high-speed fun and water-surface FPV scenarios.

The maximum speed is 10mph; the camera electric joint in N mode is set to its initial position and cannot be adjusted into the water.

- Cruise mode (C): Cruise control function. Take off, release the throttle stick and just steer the PowerDolphin.

The maximum speed is 10mph; the camera electric joint in C mode is set to its initial position and cannot be adjusted into the water.

[Notes]:To Enter Cruise mode: Hold the throttle stick in a position for 2s then release.

To Exit Cruise mode: Just move the throttle stick again to regain speed control.

## Fish finder (PowerSeeker)

### • Introduction

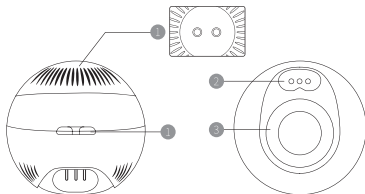

① Fishing line connector

② Charging port

③ Fish luring lamp

### • Installation

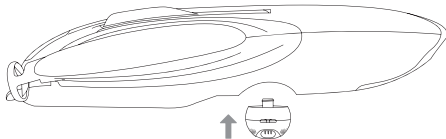

[Notes]:When the PowerSeeker is connected to another mobile device, it cannot connect to PowerDolphin. Make sure the connection to the PowerSeeker of other phones before using with PowerDolphin.

Download the App to watch the video tutorial of PowerDolphin



Please scan the QR code or go to your App store to download Vision+ 2, and watch the video tutorial in the App.

### Charging and battery level

- Charging

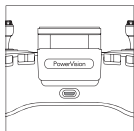
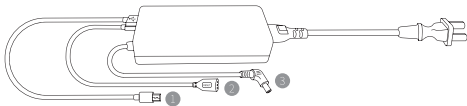

1 Remote charging port

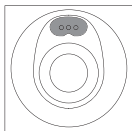

2 Fish finder charging port

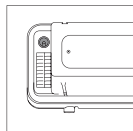

3 Battery charging port

## • Battery level

### 1. Remote (LED indicators)



>60%



20%-60%



<20%

### 2. Fish finder

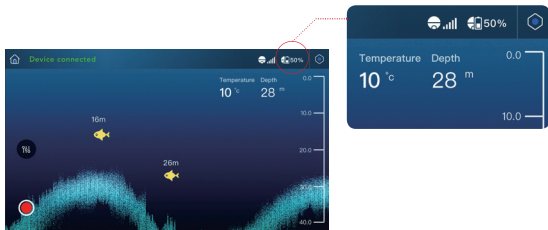

### 3. Intelligent battery

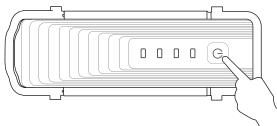

## Prepare PowerDolphin

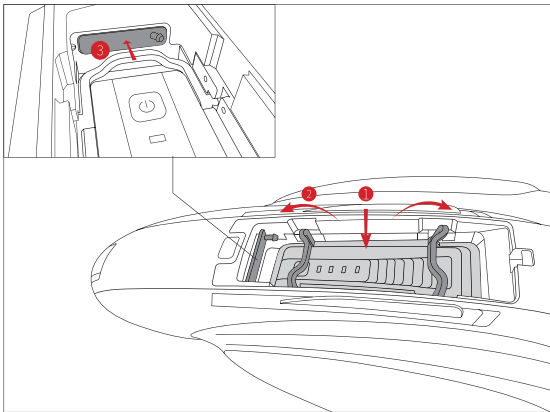

1. Install the battery and secure it into place.

- 
- ⚠** 1. Ensure that the rubber plug is secured into place to guarantee water proofing.  
2. Make sure that the battery-sealing ring is intact before installing the battery. Damage to the rubber seal will result to an unusable battery. The rubber seal can be found under the lip of the battery top.

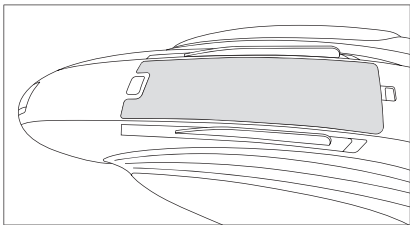

2. Snap the battery cover close.

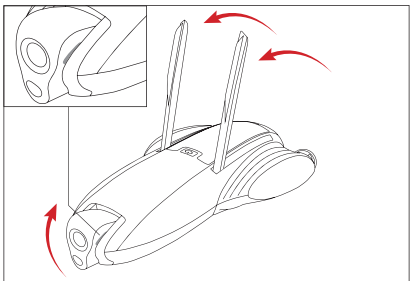

3. Unfold the antennas, and adjust the camera's manual part to a proper position.

---

**⚠** Ensure that the antennas are vertical before a sailing for the best communication outcome.



## Prepare the remote

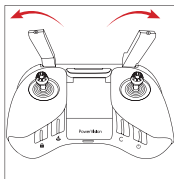

1. Unfold the antennas.

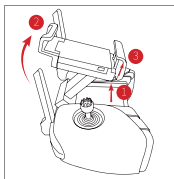

2. Lift the mobile device stand.

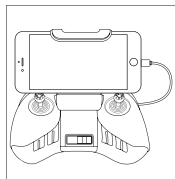

3. Secure the mobile device into place.

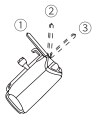

[Note] Ensure that the antennas are at positions 1 or 2 for the best communication outcome.

### • Remote operations

Default operations for control sticks (Also can be configured different ways in remote settings in the App)

Left control stick

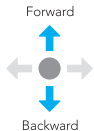

Right control stick

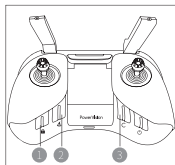
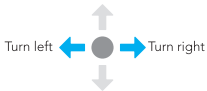

- 1 Lock/Unlock: Press and hold the button to lock/unlock the motors.
- 2 Smart return: Press and hold to return home, and short press to cancel return.
- 3 Unhook/Bait: Press and hold to perform bait drop or hook release feature, and short press to reset function.

## Sailing preparations

### • Mobile device direct connection mode

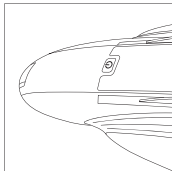

1. Press and hold the on/off button to turn on PowerDolphin. The blue side rail lights indicate power is on.

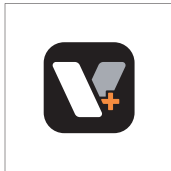

2. Start the Vision+ 2 App.



3. Follow the instructions to connect to the Wi-Fi network of the PowerDolphin or connect manually.

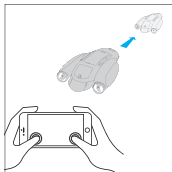

4. Put the PowerDolphin into the water, and use the unlock button on the App to unlock the device and start sailing.

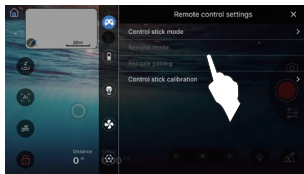

Tips:

- Use the Control stick calibration function to customize the size of control sticks on the screen and on your phone.

• Remote mode

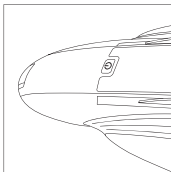

1. Press and hold the on/off button to turn on PowerDolphin. The blue side rail lights indicate power is on.

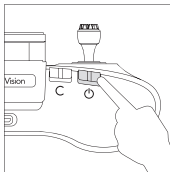

2. Press and hold the power button to turn on the remote.

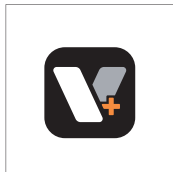

3. Start the Vision+ 2 App.

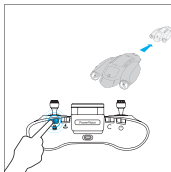

4. Put the PowerDolphin into the water, and press and hold the lock/unlock button on the remote to unlock the device and start sailing.

## Unhook

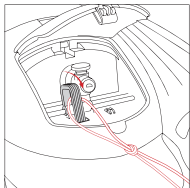

1. Hang the line on the unhook device.

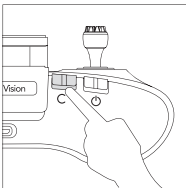

2. Perform the unhook operation.

Or

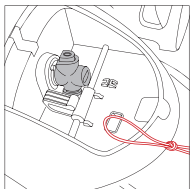
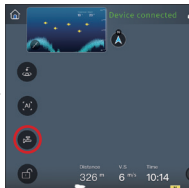

3. Operation complete.

## Bait

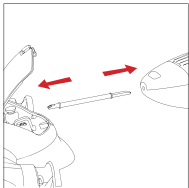

1. Install the bait drop device.

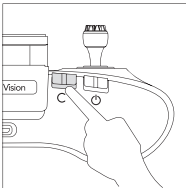

2. Perform the bait drop operation.

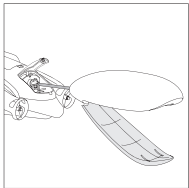
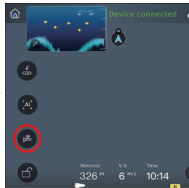

3. Operation complete.

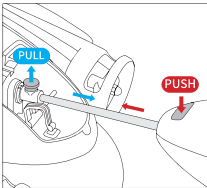

Remove the device.